

Tee (PECB) with 3 sockets STANDARD

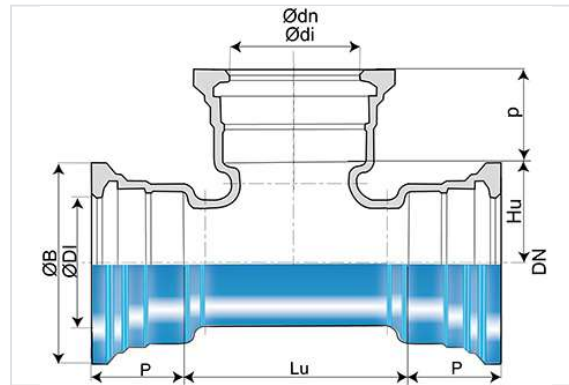

DN (mm)	Ødn (mm)	Lu (mm)	P (mm)	ØDI (mm)	ØB (mm)	Hu (mm)	p (mm)	Ødi (mm)	Mass (kg)	References
80	80	183	85	101.4	167.5	91.5	85	101.4	11.200	SSA80TE0ETT
100	100	210	88	121.4	187.5	105	88	121.4	14.900	SSB10TE0FTT
150	100	190	94	173.4	241	140	88	121.4	19.800	SSB15TE0FTT
150	150	305	94	173.4	241	152.5	94	173.4	27.000	SSB15TE0JTT
200	100	195	100	225.5	294	170	88	121.4	27.500	SSB20TE0FTT
200	150	250	100	225.5	294	177.5	94	173.4	32.300	SSB20TE0JTT
200	200	360	100	225.5	294	180	100	225.5	40.700	SSB20TE0KTT
250	250	350	105	277.8	351	165	105	277.8	49.700	SSB25TE0LTT2
350	350	495	110	381.4	464.3	250	110	381	110.000	SSB35TE0YTT
400	400	560	112	432.4	515.3	280	112	432	128.000	SSB40TE0NTT
500	500	680	117.5	535.5	628	340	117.5	535	219.000	SSB50TE0QTT
600	600	800	132.5	638.6	737	400	132.5	638	322.000	SSB60TE0RTT

Field of use:

- For drinking water and irrigation networks
- For aggressive soils (maritime soils, peaty, ...)

Main characteristics:

- External and internal coating : Blue epoxy powder 250 microns average thickness with a minimum of 200 microns, conforming to EN 14901-1 (PECB)
- In conformity with EN 545:2010 and ISO 2531:2009

Linked products

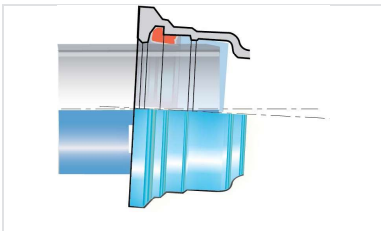

Kit Standard All Socket Tee
PECB + Standard Gasket

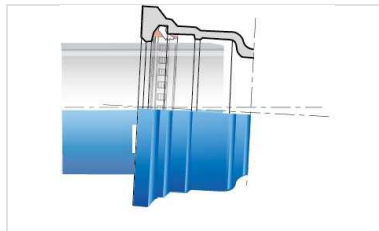

Kit Standard Fitting PECB +
Standard Vi Gasket

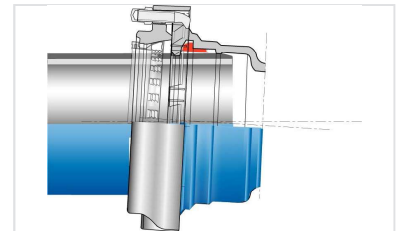

Kit Standard Fitting PECB +
Standard V+i Joint

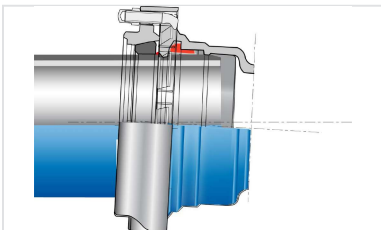

Kit Standard Fitting PECB +
Standard Ve Joint

The information on this sketch is, to the best of our knowledge correct at the time of printing. However Saint-Gobain are constantly looking at ways of improving their products and services therefore reserve the right to change without prior notice, any of the data shown. Any orders placed will be subject to our Standard Conditions of Sale, available on request.

Tee (PECB) with 2 sockets STANDARD and Rotatable Flange branch

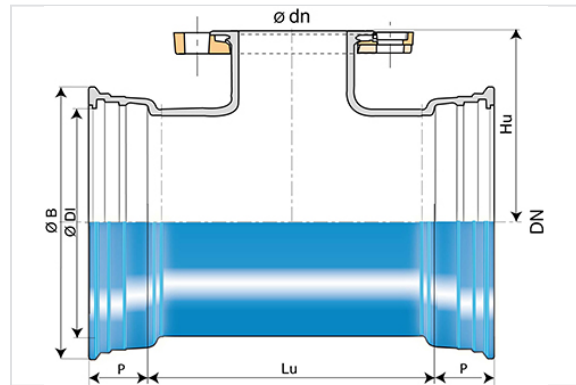
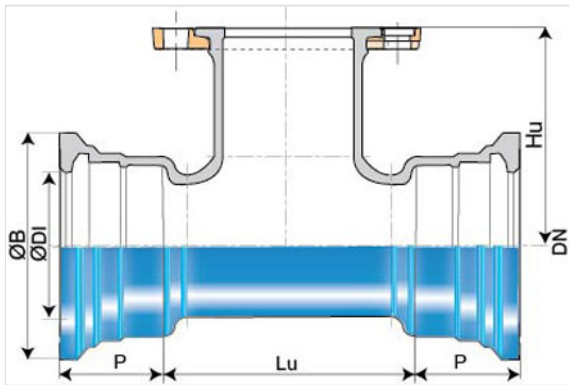

DN (mm)	Ødn (mm)	Lu (mm)	Hu (mm)	P (mm)	ØDI (mm)	ØB (mm)	PN 10		PN 16		PN 25	
							Mass (kg)	References	Mass (kg)	References	Mass (kg)	References
60	60	154	161	82	80.2	143.5	9.700	SSA60UD1CTT	9.700	SSA60UD1CTT		
80	40	145	149	85	101.4	167.5	10.200	SSA80UD1ATT	10.200	SSA80UD1ATT	10.200	SSA80UD1ATT
80	60	145	169	85	101.4	167.5	11.100	SSA80UD1CTT	11.100	SSA80UD1CTT		
80	80	183	165	85	101.4	167.5	12.500	SSA80UD1ETT	12.500	SSA80UD1ETT	12.500	SSA80UD1ETT
100	40	150	161	88	121.4	187.5	12.000	SSB10UD1ATT	12.000	SSB10UD1ATT	12.000	SSB10UD1ATT
100	60	150	181	88	121.4	187.5	12.900	SSB10UD1CTT	12.900	SSB10UD1CTT		
100	80	185	177	88	121.4	187.5	14.600	SSB10UD1ETT	14.600	SSB10UD1ETT	14.600	SSB10UD1ETT
100	100	210	180	88	121.4	187.5	16.400	SSB10UD1FTT	16.400	SSB10UD1FTT		
125	60	150	184	91	147.4	214.5	15.200	SSB12UD1CTT	15.200	SSB12UD1CTT		
125	80	165	195	91	147.4	214.5	16.800	SSB12UD1ETT	16.800	SSB12UD1ETT	16.800	SSB12UD1ETT
125	100	190	200	91	147.4	214.5	18.500	SSB12UD1FTT	18.500	SSB12UD1FTT		
125	125	267	200	91	147.4	214.5	23.000	SSB12UD1GTT	23.000	SSB12UD1GTT		
150	40	154	176	94	173.4	241	17.100	SSB15UD1ATT	17.100	SSB15UD1ATT	17.100	SSB15UD1ATT
150	60	154	196	94	173.4	241	18.000	SSB15UD1CTT	18.000	SSB15UD1CTT		
150	80	165	210	94	173.4	241	19.600	SSB15UD1ETT	19.600	SSB15UD1ETT	19.600	SSB15UD1ETT
150	100	190	215	94	173.4	241	21.400	SSB15UD1FTT	21.400	SSB15UD1FTT		
150	150	305	220	94	173.4	241	29.500	SSB15UD1JTT	29.500	SSB15UD1JTT		
200	60	159	229.5	100	225.5	294	26.000	SSB20UD1CTT	26.000	SSB20UD1CTT		
200	80	170	240	100	225.5	294	27.000	SSB20UD1ETT	27.000	SSB20UD1ETT	27.000	SSB20UD1ETT
200	100	195	245	100	225.5	294	29.100	SSB20UD1FTT	29.100	SSB20UD1FTT	29.600	SSB20UD3FTT

DN (mm)	Ødn (mm)	Lu (mm)	Hu (mm)	P (mm)	ØDI (mm)	ØB (mm)	PN 10		PN 16		PN 25	
							Mass (kg)	References	Mass (kg)	References	Mass (kg)	References
200	150	250	245	100	225.5	294	34.900	SSB20UD1JTT	34.900	SSB20UD1JTT		
200	200	360	260	100	225.5	294	44.700	SSB20UD1KTT	44.600	SSB20UD2KTT		
250	60	165	260	105	277.8	351	31.400	SSB25UD1CTT2	31.400	SSB25UD1CTT2		
250	80	155	265	105	277.8	351	31.300	SSB25UD1ETT2	31.300	SSB25UD1ETT2	31.300	SSB25UD1ETT2
250	150	235	255	105	277.8	351	39.000	SSB25UD1JTT2	39.000	SSB25UD1JTT2		
250	200	290	265	105	277.8	351	47.000	SSB25UD1KTT2	47.200	SSB25UD2KTT2		
250	250	350	275	105	277.8	351	55.800	SSB25UD1LTT2	55.800	SSB25UD2LTT2		
300	60	165	290	110	329.8	408.3	41.700	SSB30UD1CTT2	41.700	SSB30UD1CTT2		
300	80	155	295	110	329.8	408.3	41.500	SSB30UD1ETT2	41.500	SSB30UD1ETT2	41.500	SSB30UD1ETT2
300	100	180	275	110	329.8	408.3	41.800	SSB30UV1FTT2	41.800	SSB30UV1FTT2		
300	150	235	285	110	329.8	408.3	48.800	SSB30UD1JTT2	48.800	SSB30UD1JTT2		
300	200	295	295	110	329.8	408.3	58.300	SSB30UD1KTT2	58.500	SSB30UD2KTT2		
300	250	380	330	110	329.8	408.3			67.900	SSB30UD2LTT2		
300	300	410	315	110	329.8	408.3	79.100	SSB30UD1MTT2	78.600	SSB30UD2MTT2		
350	60	170	320	110	381.9	464.3	48.405	SSB35UD1CTT2	48.405	SSB35UD1CTT2	48.405	SSB35UD3CTT2
350	80	185	325	110	381.9	464.3	50.085	SSB35UD1ETT2	50.085	SSB35UD1ETT2	50.085	SSB35UD1ETT2
350	150	270	340	110	381.9	464.3	59.850	SSB35UD1JTT2	59.850	SSB35UD1JTT2	61.950	SSB35UD3JTT2
350	200	300	325	110	381.9	464.3	66.500	SSB35UD1KTT2	66.700	SSB35UD2KTT2	68.000	SSB35UD3KTT2
350	250	385	360	110	381.9	464.3	78.500	SSB35UD1LTT2	78.500	SSB35UD2LTT2		
350	300	410	345	110	381.9	464.3	84.800	SSB35UD1MTT2	84.300	SSB35UD2MTT2		
350	350	485	380	110	381.4	464.3	131.000	SSB35UD1YTT	132.000	SSB35UD2YTT		
400	80	175	330	112	432.9	515.3	61.000	SSB40UD1ETT2	61.000	SSB40UD1ETT2	61.000	SSB40UD1ETT2
400	150	245	345	112	432.9	515.3	68.460	SSB40UD1JTT2	68.460	SSB40UD1JTT2		
400	200	300	355	112	432.9	515.3	77.385	SSB40UD1KTT2	77.595	SSB40UD2KTT2		
400	250	385	390	112	432.9	515.3	90.720	SSB40UD1LTT2	90.720	SSB40UD2LTT2	93.450	SSB40UD3LTT2
400	300	415	375	112	432.9	515.3	97.545	SSB40UD1MTT2	97.020	SSB40UD2MTT2		
400	400	535	395	110	432.9	515.3	121.590	SSB40UD1NTT2	126.320	SSB40UD2NTT2	135.770	SSB40UD3NTT2
450	150	270	400	115.5	484	573	86.625	SSB45UD1JTT2	86.625	SSB45UD1JTT2	88.725	SSB45UD3JTT2
450	450	600	460	115.5	483.5	573	201.000	SSB45UD1PTT	207.000	SSB45UD2PTT		
500	150	325	430	117.5	535.5	628	132.200	SSB50UD1JTT	132.200	SSB50UD1JTT	134.200	SSB50UD3JTT
500	200	305	415	117.5	536	628	108.800	SSB50UD1KTT2	109.000	SSB50UD2KTT2	110.400	SSB50UD3KTT2
500	250	443	450	117.5	535.5	628	149.600	SSB50UD1LTT				
500	300	443	460	117.5	535.5	628	188.000	SSB50UD1MTT	188.000	SSB50UD2MTT		

DN (mm)	Ødn (mm)	Lu (mm)	Hu (mm)	P (mm)	ØDI (mm)	ØB (mm)	PN 10		PN 16		PN 25	
							Mass (kg)	References	Mass (kg)	References	Mass (kg)	References
500	400	540	455	117.5	536	628	159.100	SSB50UD1NTT2	163.800	SSB50UD2NTT2		
500	500	655	475	117.5	536	628	256.305	SSB50UD1QTT2	269.955	SSB50UD2QTT2		
600	150	340	490	132.5	638.6	737	168.000	SSB60UD1JTT	168.000	SSB60UD1JTT		
600	300	452	520	132.5	638.6	737	230.300	SSB60UD1MTT	229.600	SSB60UD2MTT		
600	400	545	515	132.5	639.1	737	208.000	SSB60UD1NTT2	213.000	SSB60UD2NTT2		
600	600	800	580	132.5	638.6	737	373.000	SSB60UD1RTT	398.000	SSB60UD2RTT		
700	150	365	520	150	742.2	861	262.200	SSB70UD1JTT	262.200	SSB70UD1JTT	263.000	SSB70UD3JTT
700	200	365	525	150	742.2	861	265.000	SSB70UD1KTT	265.000	SSB70UD2KTT		
700	400	585	555	150	742.2	861	347.000	SSB70UD1NTT	351.000	SSB70UD2NTT		
700	600	915	585	150	742.2	861	474.000	SSB70UD1RTT	499.000	SSB70UD2RTT	502.000	SSB70UD3RTT
800	150	355	580	160	846.3	972	332.000	SSB80UD1JTT	332.000	SSB80UD1JTT	333.000	SSB80UD3JTT
800	200	355	585	160	846.3	972	335.000	SSB80UD1KTT	336.000	SSB80UD2KTT		
800	400	575	615	160	846.3	972	430.000	SSB80UD1NTT	435.000	SSB80UD2NTT		
800	600	1015	645	160	846.3	972	617.000	SSB80UD1RTT	642.000	SSB80UD2RTT	645.000	SSB80UD3RTT
900	200	375	645	175	949.4	1080	420.000	SSB90UD1KTT	419.000	SSB90UD2KTT		
900	400	595	675	175	949.4	1080	532.000	SSB90UD1NTT	536.000	SSB90UD2NTT	545.000	SSB90UD3NTT
900	600	1145	705	175	949.4	1080	798.000	SSB90UD1RTT	823.000	SSB90UD2RTT	826.000	SSB90UD3RTT
1000	150	379	705	185	1052.5	1189	447.000	SSC10UD1JTT	447.000	SSC10UD1JTT		
1000	200	379	705	185	1052.5	1189	510.000	SSC10UD1KTT	510.000	SSC10UD2KTT	512.000	SSC10UD3KTT
1000	400	598.5	735	185	1052.5	1189	639.000	SSC10UD1NTT	644.000	SSC10UD2NTT	653.000	SSC10UD3NTT
1000	600	1258.5	765	185	1052.5	1189	1007.000	SSC10UD1RTT	1032.000	SSC10UD2RTT	1035.000	SSC10UD3RTT
1000	300	598.5	720	185	1052.5	1189			569.000	SSC10UD2MTT	574.000	SSC10UD3MTT
1100	200	822.5	880	150	1152	1298			910.900	SSC11UD2KTT		
1100	400	822.5	835	150	1152	1298			1003.000	SSC11UD2NTT		
1100	600	822.5	885	150	1152	1298	907.000	SSC11UD1RTT	932.000	SSC11UD2RTT		
1200	200	855	880	195	1263	1412	949.000	SSC12UD1KTT	949.000	SSC12UD2KTT		
1200	300	855	838	195	1263	1412	927.000	SSC12UD1MTT				
1200	400	855	835	195	1263	1412	938.000	SSC12UD1NTT				
1200	600	855	885	195	1263	1412	953.000	SSC12UD1RTT				
1400	600	1010	980	255	1467	1600	1542.000	SSC14UD1RTT	1567.000	SSC14UD2RTT	1567.750	SSC14UD3RTT
1400	250	1010	1000	255	1467	1600			1511.000	SSC14UD2LTT		
1600	300	1050	1050	275	1673	1820			1967.000	SSC16UD2MTT	1979.000	SSC16UD3MTT
1800	600	1125	1200	258	1881.7	2038					2388.000	SSC18UD3RTT



NATURAL SUPPLY, TREATMENT AND DISTRIBUTION DN 60 2000

22/10/2025
WARSF21STD366

DN (mm)	Ødn (mm)	Lu (mm)	Hu (mm)	P (mm)	ØDI (mm)	ØB (mm)	PN 10		PN 16		PN 25	
							Mass (kg)	References	Mass (kg)	References	Mass (kg)	References
2000	300	1110	1265	290	2089	2269			3201.000	SSC20UD2MTT		

Field of use:

- For drinking water and irrigation networks
- For aggressive soils (maritime soils, peaty, ...)

Main characteristics:

- External and internal coating : Blue epoxy powder 250 microns average thickness with a minimum of 200 microns, conforming to EN 14901-1 (PECB)
- In conformity with EN 545:2010 and ISO 2531:2009

Linked products

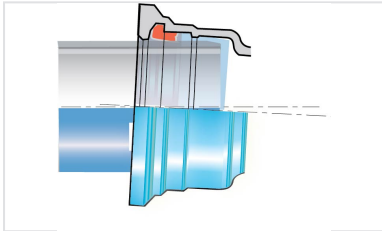

Kit Standard Double Socket Tee with flanged branch
PECB + Standard Gasket

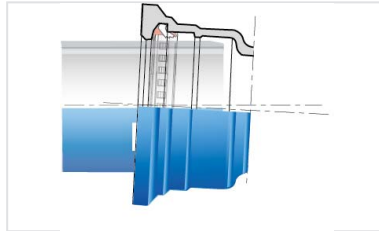

Kit Standard Fitting PECB +
Standard Vi Gasket

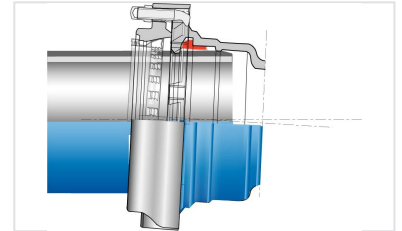

Kit Standard Fitting PECB +
Standard V+i Joint

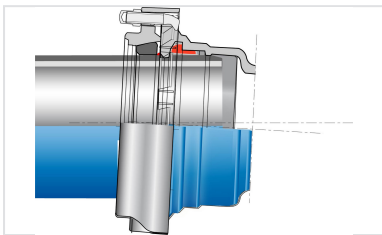

Kit Standard Fitting PECB +
Standard Ve Joint

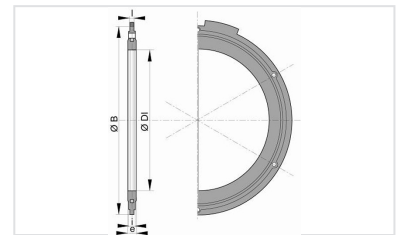

Flanged joint with
metallized steel bolts and
nuts

The information on this sketch is, to the best of our knowledge correct at the time of printing. However Saint-Gobain are constantly looking at ways of improving their products and services therefore reserve the right to change without prior notice, any of the data shown. Any orders placed will be subject to our Standard Conditions of Sale, available on request.

Flange Socket (PECB) with socket STANDARD (and Rotatable Flange or Fixed Flange)

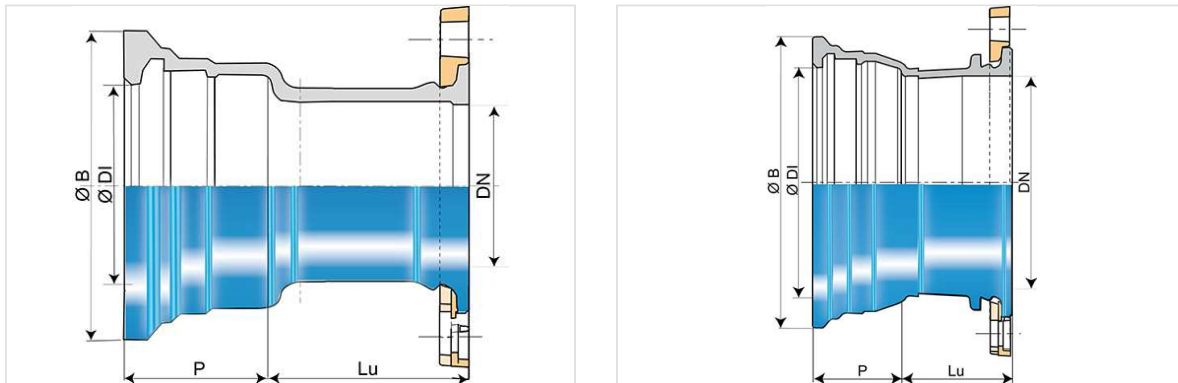

DN (mm)	Lu (mm)	P (mm)	ØDI (mm)	ØB (mm)	PN 10		PN 16		PN 25	
					Mass (kg)	References	Mass (kg)	References	Mass (kg)	References
60	142	82	80.2	143.5	5.900	SSA60BE10TT	5.900	SSA60BE10TT		
80	110	85	101.4	167.5	7.200	SSA80BE10TT	7.200	SSA80BE10TT	7.200	SSA80BE10TT
100	110	88	121.4	187.5	8.700	SSB10BE10TT	8.700	SSB10BE10TT	10.000	SSB10BE30TT
125	110	91	147.4	214.5	11.000	SSB12BE10TT	11.000	SSB12BE10TT		
150	115	94	173.4	241	13.800	SSB15BE10TT	13.800	SSB15BE10TT	14.800	SSB15BE30TT
200	120	100	225.5	294	20.400	SSB20BE10TT	20.300	SSB20BE20TT	23.500	SSB20BE30TT
250	135	105	277.3	351	31.300	SSB25BE10TT	30.900	SSB25BE20TT	33.900	SSB25BE30TT
300	130	110	329.3	408.3	42.000	SSB30BE10TT	41.300	SSB30BE20TT	44.900	SSB30BE30TT
350	130	110	381.9	464.3	49.665	SSB35BE10TT2	50.820	SSB35BE20TT2	56.700	SSB35BE30TT2
400	135	112	432.9	515.3	60.060	SSB40BE10TT2	64.785	SSB40BE20TT2	74.235	SSB40BE30TT2
450	140	115.5	484	573	70.875	SSB45BE10TT2	75.915	SSB45BE20TT2	86.100	SSB45BE30TT2
500	145	117.5	536	628	89.670	SSB50BE10TT2	103.320	SSB50BE20TT2	109.620	SSB50BE30TT2
600	155	132.5	639.1	737	122.640	SSB60BE10TT2	148.890	SSB60BE20TT2	152.040	SSB60BE30TT2
700	190	150	742.2	861	161.000	SSB70BE10TT	166.000	SSB70BE20TT	196.000	SSB70BE30TT
800	200	160	846.3	972	211.000	SSB80BE10TT	220.000	SSB80BE20TT	274.000	SSB80BE30TT
900	210	175	949.4	1080	258.000	SSB90BE10TT	268.000	SSB90BE20TT	319.000	SSB90BE30TT
1000	220	185	1052.5	1189	342.000	SSC10BE10TT	359.000	SSC10BE20TT	425.000	SSC10BE30TT
1100	220	150	1155	1298	350.000	SSC11BE10TT	386.000	SSC11BE20TT	459.000	SSC11BE30TT
1200	240	195	1263	1412	443.000	SSC12BE10TT	484.000	SSC12BE20TT		
1400	310	255	1467	1600	716.000	SSC14BE10TT	768.000	SSC14BE20TT		

DN (mm)	Lu (mm)	P (mm)	ØDI (mm)	ØB (mm)	PN 10		PN 16		PN 25	
					Mass (kg)	References	Mass (kg)	References	Mass (kg)	References
1600	330	275	1673	1820			1046.000	SSC16BE20TT	1203.000	SSC16BE30TT
1800	387	258	1881.7	2038	1212.000	SSC18BE10TT				
2000	395	290	2089	2269	1659.000	SSC20BE10TT				

Field of use:

- For drinking water and irrigation networks
- For aggressive soils (maritime soils, peaty, ...)

Main characteristics:

- External and internal coating : Blue epoxy powder 250 microns average thickness with a minimum of 200 microns, conforming to EN 14901-1 (PECB)
- In conformity with EN 545:2010 and ISO 2531:2009

Linked products

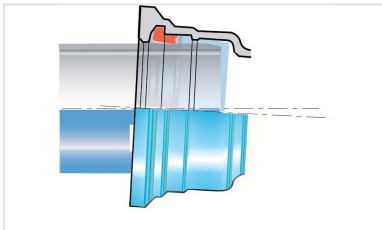

Kit Standard Flanged
 Socket PECB + Standard
 Gasket

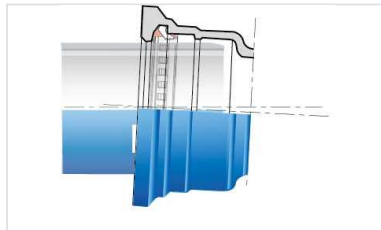

Kit Standard Fitting PECB +
 Standard Vi Gasket

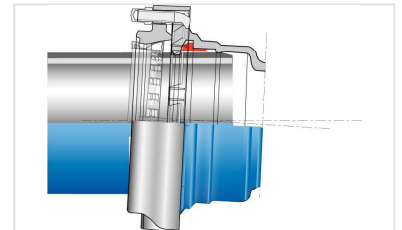

Kit Standard Fitting PECB +
 Standard V+i Joint

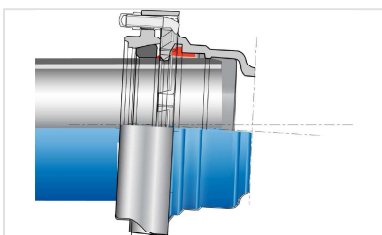

Kit Standard Fitting PECB +
 Standard Ve Joint

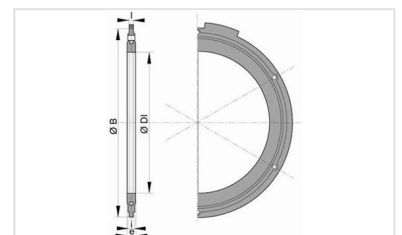

Flanged joint with hot
 galvanized steel bolts, nuts
 and washers

The information on this sketch is, to the best of our knowledge correct at the time of printing. However Saint-Gobain are constantly looking at ways of improving their products and services therefore reserve the right to change without prior notice, any of the data shown. Any orders placed will be subject to our Standard Conditions of Sale, available on request.