

Nr. 6120

ISO fitting with external thread, POM

with external thread EN 102261



Standards

ISO:

- For PE-pipes according to EN 12201 and DIN 8074 | to PN 16; up to 30 °C medium temperature, also for vacuum (with support liner)
- restraint acc. to DIN 8076 T1/T3
- with special clamp for PVC pipes acc. to EN 1452-2
- External thread EN 10226-1

Construction features

ISO:

- The function of the ISO pipe fitting is clear and simple: the O-ring made of highly elastic elastomer seals even when depressurized due to its pretension on the pipe.
- As the water pressure and pipe tension increase, the sealing and grip rings are compressed further into the conical chamber, thus increasing the sealing and gripping effect
- The gripping and sealing functions only act on the outer diameter of the pipe; therefore only one fitting is required for all pressure ratings up to PN 16
- The joint is flexible; the fitting can be turned on the pipe and disassembled on demand without affecting the grip or seal. The installation of the fitting is quick and simple.
- The POM fitting in the new copolymer version is UV-stabilized and offers excellent long-term stability
- The colored dust caps of the POM fitting indicate the different leading medium (gas, water) and offer protection against contamination
- In POM fittings all internal threads are reinforced with a stainless steel ring

All ISO pipe fittings can also be supplied for PVC pipes with a specialised grip ring at extra cost.



Nr. 6120

ISO fitting with external thread, POM

with external thread EN 102261

Materials

Body	POM (Polyoxymethylene)
Grip ring	POM (Polyoxymethylene)
O-ring gasket	Elastomer

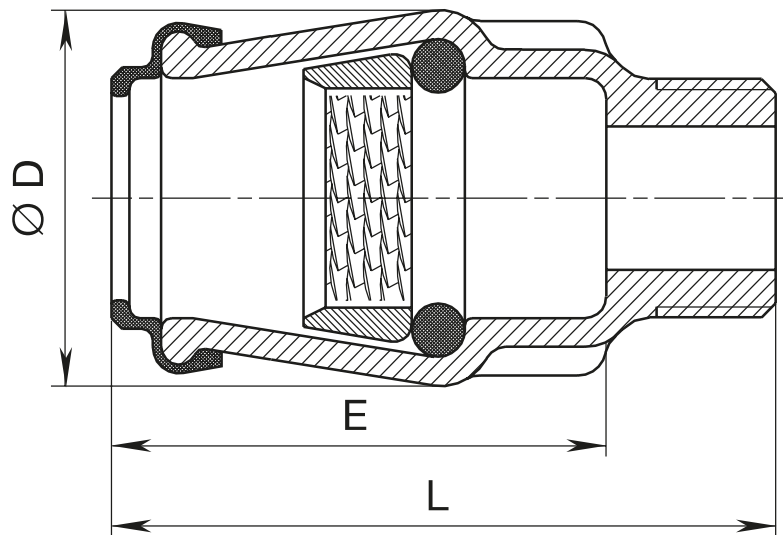

DN	PN	Weight	L	E	Ød	Ø pipe	Thread
D20-1/2"	PN16	0.032	68	48	39	20	1/2"
D25-3/4"	PN16	0.06	82	58	43	25	3/4"
D32-1"	PN16	0.1	95	70	53	32	1"
D40-1 1/4"	PN16	0.203	110	82	72	40	1 1/4"
D50-1 1/2"	PN16	0.27	126	99	83	50	1 1/2"
D63-2"	PN16	0.49	144	110	99	63	2"

All illustrations, technical data, dimensions (in mm) and weights (all weights specified in kg) are non-binding. Subject to changes and printing errors